

# **TEKNISK INFO**

*TECHNICAL INFO*

### GROUND FLOOR

METRO

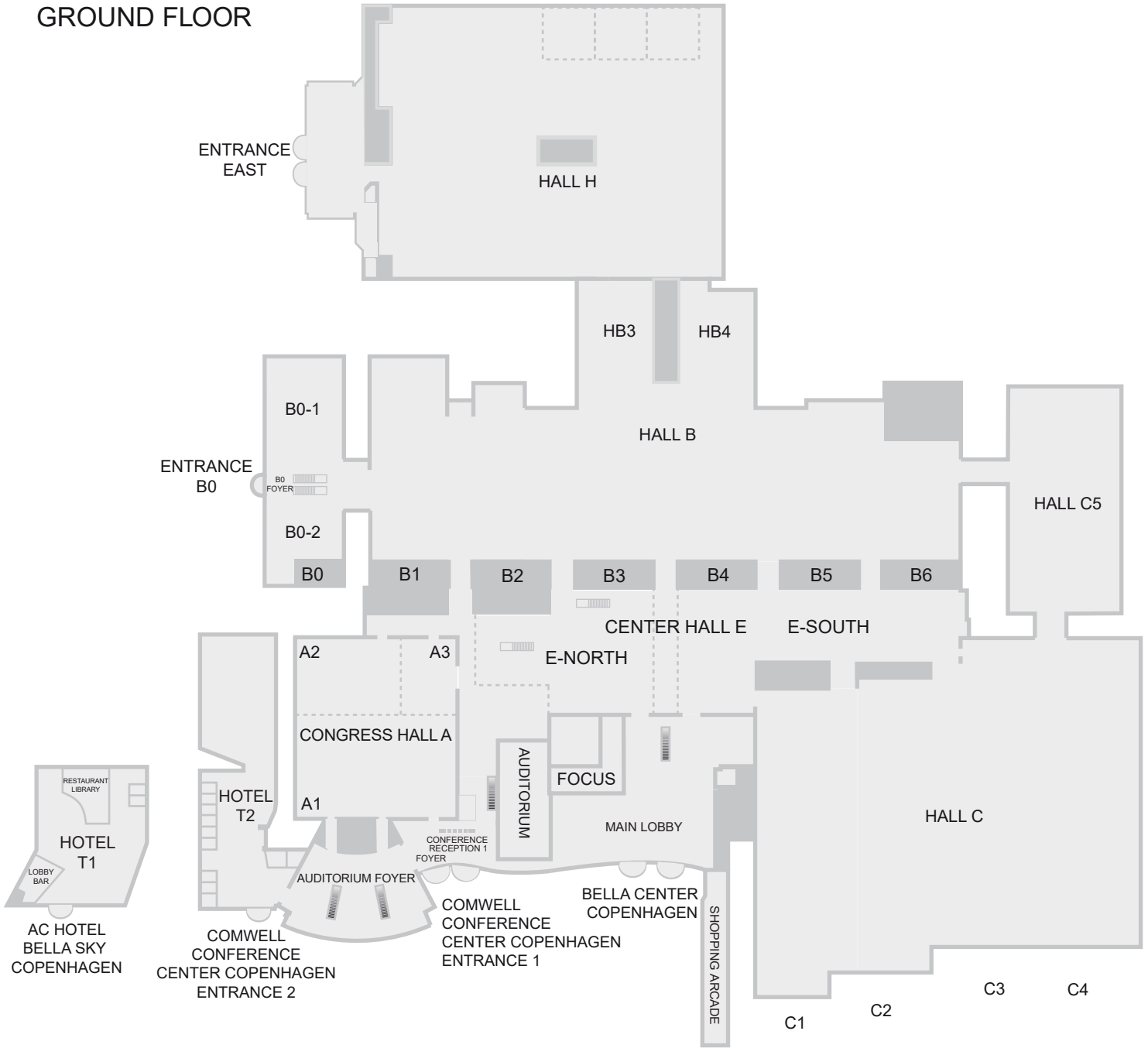

### FIRST FLOOR

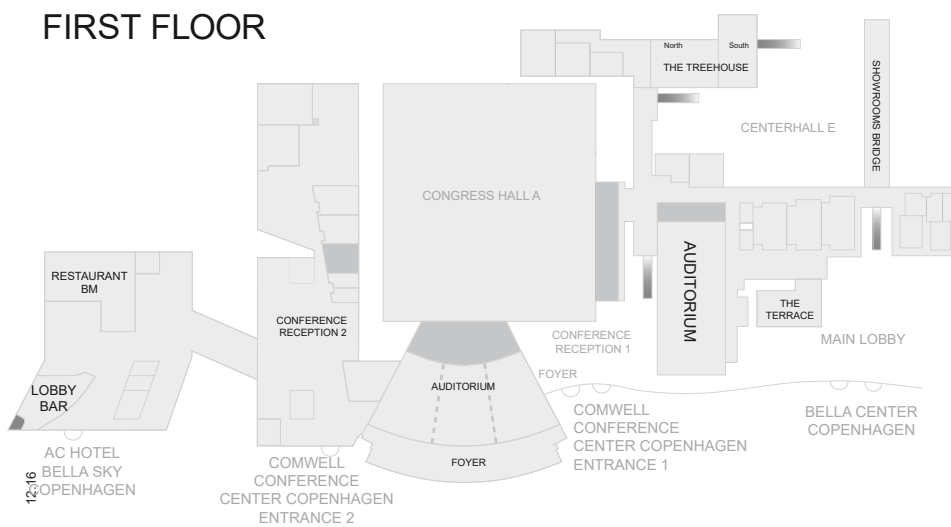

## Indholdsfortegnelse

På de kommende sider finder du nyttige informationer om alle vores udstillingshaller. Vi håber det hjælper i planlægningsfasen. Har du yderligere spørgsmål, er du velkommen til at kontakte os/Bella Center.

## Contents

On the following pages, you will find detailed information on our exhibition halls. We do hope that this info helps your planning. If you have additional questions, please contact us/Bella Center.

<input type="checkbox"/> Bella Center oversigt	<input type="checkbox"/> Bella Center floor plan	2
<input checked="" type="checkbox"/> Indholdsfortegnelse	<input checked="" type="checkbox"/> Contents	3
<input type="checkbox"/> Kongressal A – opbygning og plantegning	<input type="checkbox"/> Congress Hall A – a brief description	4-5
<input type="checkbox"/> Auditorium Foyer – opbygning og plantegning	<input type="checkbox"/> Auditorium Foyer – a brief description	6-7
<input type="checkbox"/> Kongres Foyer – opbygning og plantegning	<input type="checkbox"/> Congress Foyer – a brief description	8-9
<input type="checkbox"/> Hal B – opbygning og plantegning	<input type="checkbox"/> Hall B – a brief description	10-13
<input type="checkbox"/> Hal HB3 / HB4 – opbygning og plantegning	<input type="checkbox"/> Halls HB3 / HB4 – a brief description	14-15
<input type="checkbox"/> Hal C – opbygning og plantegning	<input type="checkbox"/> Hall C – a brief description	16-18
<input type="checkbox"/> Hal C5 – opbygning og plantegning	<input type="checkbox"/> Hall C5 – a brief description	19-20
<input type="checkbox"/> Hal E / Centerhallen – opbygning og plantegning	<input type="checkbox"/> Hall E / Center Hall – a brief description	21-23
<input type="checkbox"/> Hal H / Østhallen – opbygning og plantegning	<input type="checkbox"/> Hall H / East Hall – a brief description	24-26

# Kongressal A

## – sådan ser den ud

### Adgang til hallen

På tegningen kan du se numrene for de enkelte porte, der giver adgang til hallen.

### Hallens frihøjde

Hallens frihøjde er variabel op til 8,90 m målt fra underkanten af loftets lyssætning.

### Belysning

I hallens loftflåde hænger der lysarmatur med 3x14W lavenergi lysrør til hallens generelle belysning. Lysstyrken kan dæmpes. Halogenbelysning lavet som stjernehimme kan tændes i 3 niveauer. 30%, 60% og 100%

### Loft

Installation af el, vvs og netværk trækkes fra loftet og ned til standene.

### Wirer

De fleste steder i hallen kan vi montere wirer med en vægt fra 0-75 kg. Wirer med en vægt over 75 kg kræver speciel godkendelse.

### Gulv

Gulvet er dækket af mørkeblåt gulvtæppe.

Gulvet kan klare følgende belastninger:  
Enkeltkraft fordelt på 15x15 cm = 4.000 kg.

Kørsel i områderne med udendørskøretøjer er ikke tilladt.

### Vægge

Dækket af mørkt stofgardin fra loft til gulv.

### Luft

Hallen har aircondition.

## Congress Hall A – a brief description

### Accessing the hall

Please refer to the floorplan where access points are indicated.

### Ceiling height

The hall, ceiling heights vary up to 8.90 m, measured from the under edge of the ceiling flood lighting.

### General lighting

Hall ceiling fleet with 3x14W fluorescent low-energy light fittings to the hall general lighting. The brightness can be regulated. Halogen lighting made as starry sky and can be turned into 3 levels. 30%, 60% and 100%.

### Ceiling

Power supplies, network and telephone cables as well as plumbing and compressed air will be run into your stand via the hall ceiling.

### Drop wires

Most places in the hall we can mount drop wires with a weight up to 75 kg. Drop wires exceeding 75 kg will require a special approval.

### Floor

The hall floor is covered with dark blue carpet.

The floor can carry the following loads:  
Single-point load per 15x15 cm = 4,000 kg.

Outdoor vehicles are not allowed in the area.







### Walls

Covered by dark cloth textiles from ceiling to floor.







### Air

The hall has air conditioning.

## Kongressal A

-  3x3 meter modul
-  Loftflåder, modul 3x3 meter
-  Brandskab, L75xB25xH85cm, må ikke tildækkes
-  Tryk for brandalarmering
-  Foldevæg med depot
-  Gitterspær
-  Stofgardin

## Congress Hall A

-  3x3 meter modular grid
-  Ceiling grid, 3x3 meter
-  Fire hose, cabinet L75xW25xH85cm, must not be concealed
-  Fire Alarm
-  Movable wall
-  Truss
-  Cloth Textile

# Kongressal A, Loffflåder Congress Hall A, Ceiling Grids

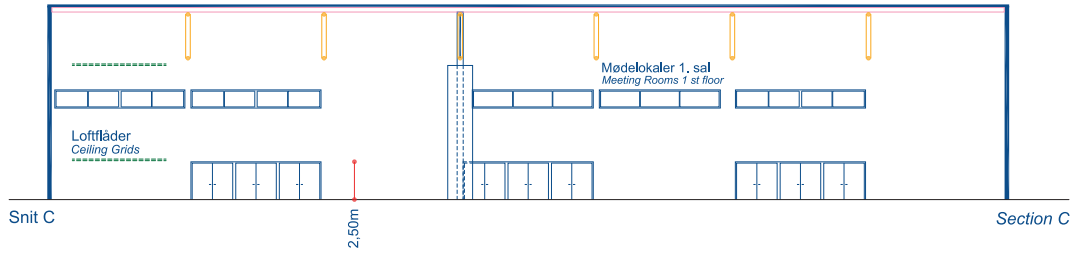
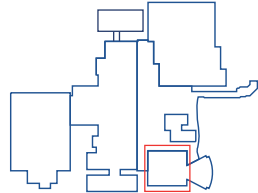
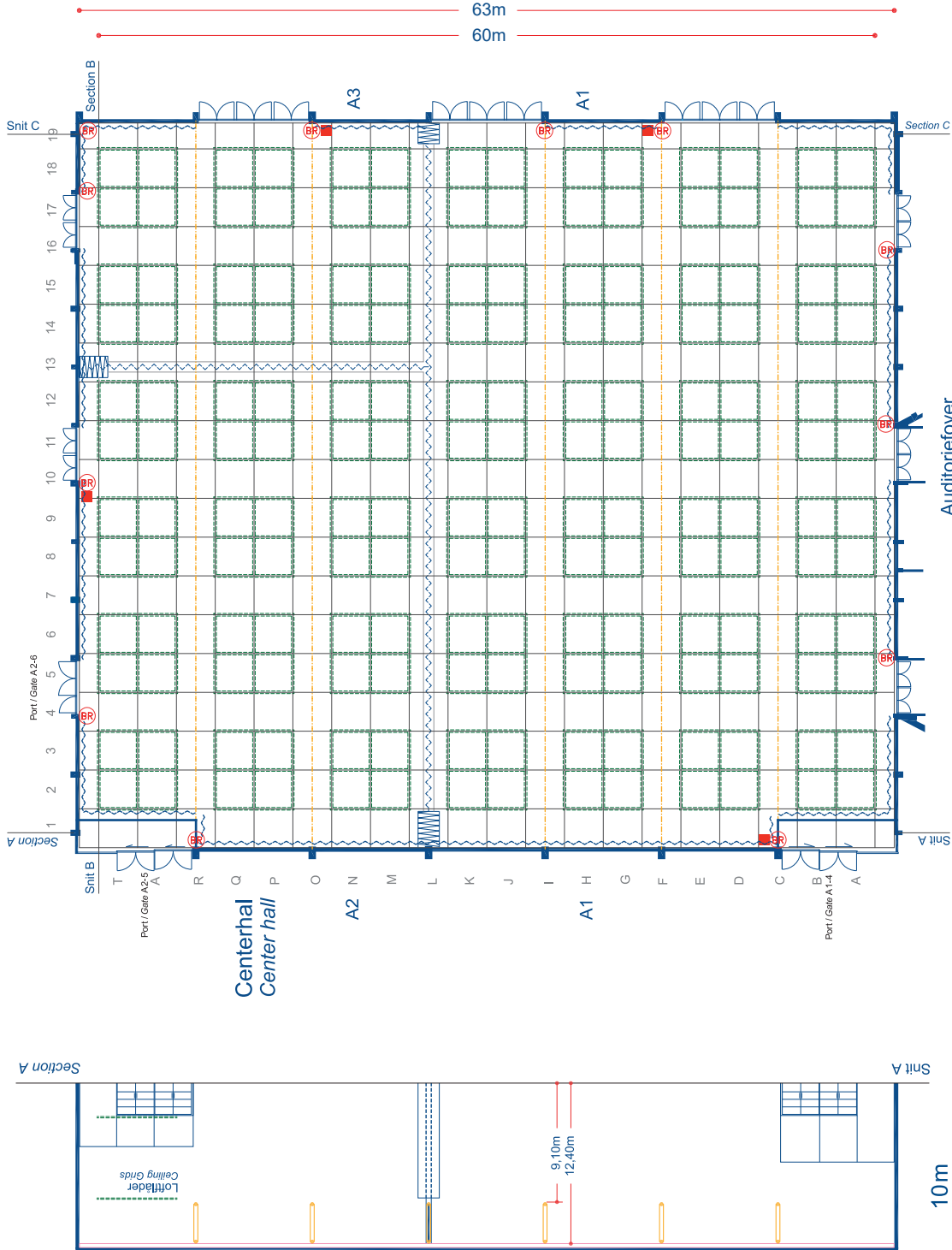
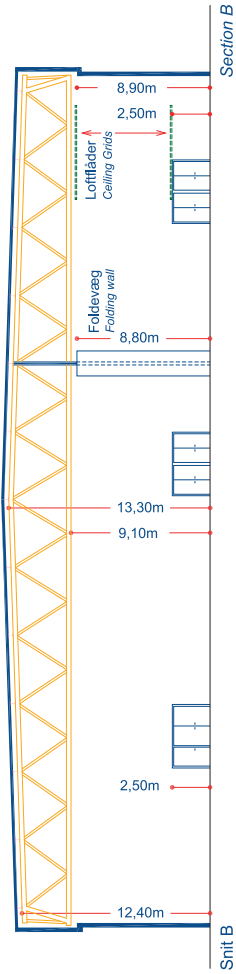

# Auditorium Foyer

## – sådan ser den ud

### Adgang til Auditorium Foyer

På tegningen kan du se adgangen til Auditorium Foyer.

### Auditorium Foyer frihøjde

Foyerens frihøjde er 385 cm, målt fra underkanten af loftet.

### Belysning

Der er monteret permanente lamper for generel belysning af området (Indbygningsarmatur, 26 Watt lavenergi), samt LED lamper i nedre foyer, der kan skifte farve. Endvidere pynte lamper i siderne af nedre foyer.

### Loft

Installation af el og netværk trækkes fra loft.

### Wirer

Af konstruktionsmæssige årsager er det ikke muligt at rigge i loftet.

### Gulv

Gulvet er af marmor og kan klare følgende belastninger:

Enkelkraft fordelt på 15 x 15 cm = 400 kg

Nyttelast = 400 kg/m<sup>2</sup>

Kørsel i området er ikke tilladt.

### Luft

Auditorium Foyeren har aircondition.

## Auditorium Foyer – a brief description

### Accessing the Auditorium Foyer

Please refer to the floor plan where access points are indicated.

### Ceiling height

Measured from the floor to the lower edge of the ceiling the height is 385 cm.

### General lighting

Build in - luminaire, mounted with 26 Watt low energy lighting, evenly distributed throughout the hall ceiling provide the general lighting. LED lighting in the lower lobby which can change color. Decorative lighting on the sides in the lower lobby.

### Ceiling

Networking cabling will be supplied from the ceiling.

### Wirer

For construction reasons it is not possible to mount wirer in the ceiling.

### Floor

The floor is marble and can carry the following loads:

Single point loads per 15 x 15 cm = 400 kg

Net loads = 400 kg/m<sup>2</sup>

Driving is not permitted.

### Air

The Auditorium Foyer has air conditioning.

## Auditorium Foyer



3 x 3mtr modul



Søjle Ø=40cm



Søjle med glasbord



Brandskab - må ikke tildækkes



Hallens frihøjder



Vand



Podie



Banner skinner H=3,82m

## Auditorium Foyer



3x3mtr modular grid



Pillar (concrete) Ø=40cm



Pillar (concrete) with glass table



Fire hose - must not be concealed



Ceiling height



Water



Podium



Banner rails H=3,82m

# Auditorium Foyer

## Auditorium Foyer

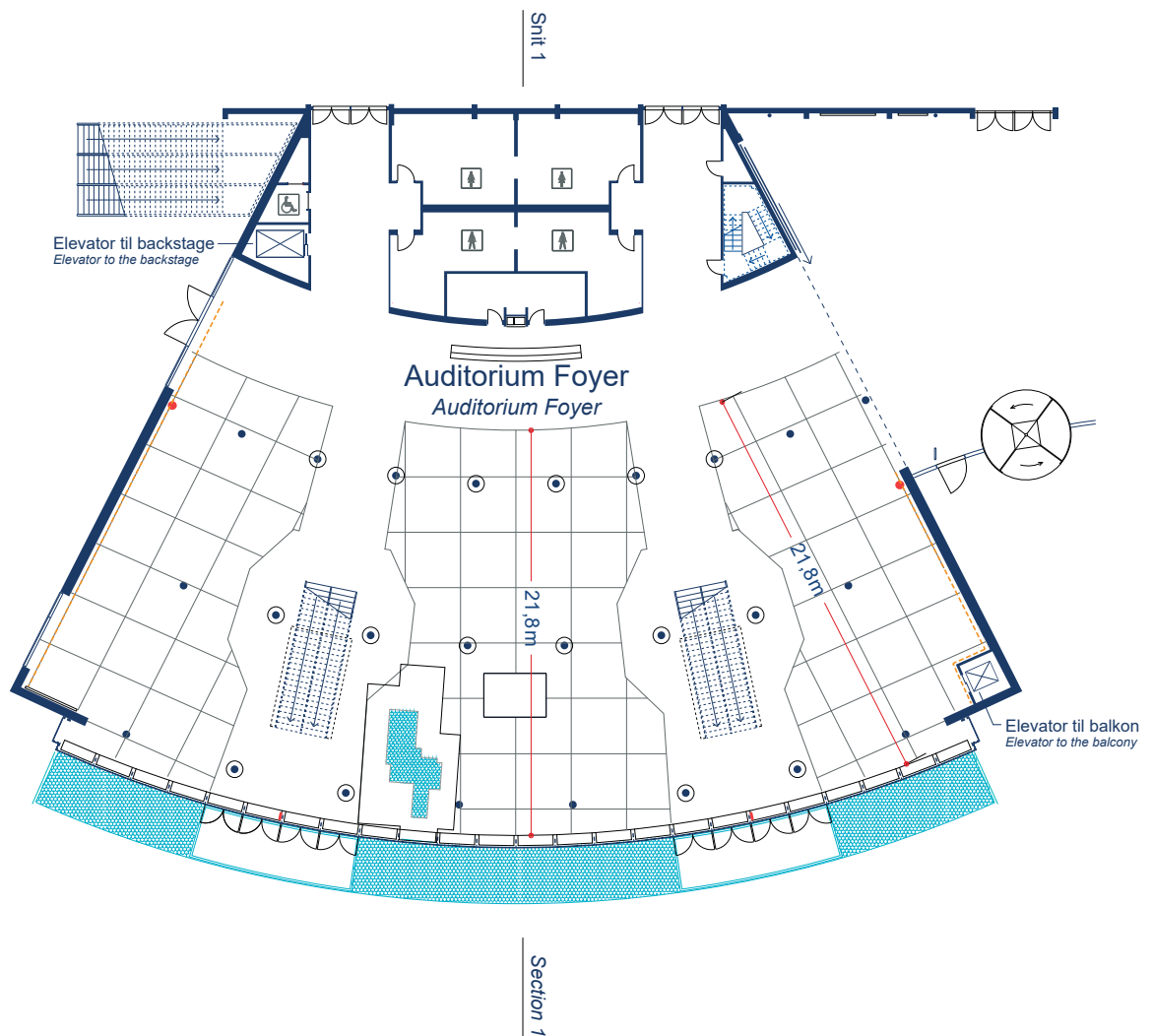
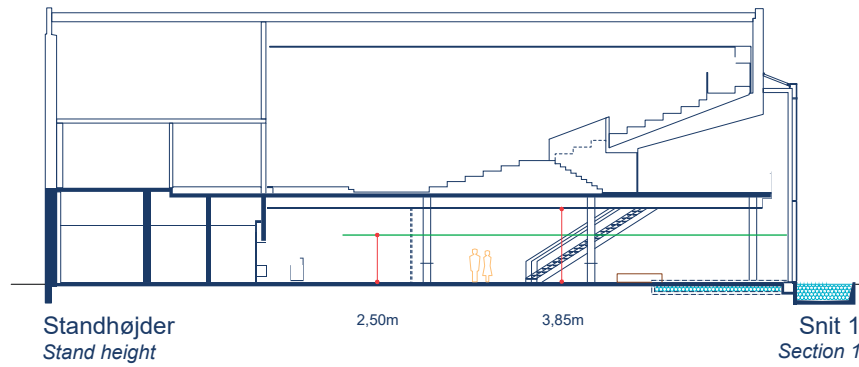
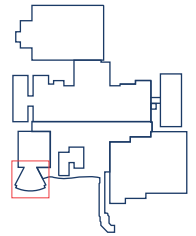

5m  
1:400

# Kongres Foyer

## – sådan ser den ud

### Adgang til Kongres Foyer

På tegningen kan du se adgangen til Kongres Foyer.

### Kongres Foyer frihøjde

Hallens frihøjde er 250 cm målt fra underkanten af loftets lyssætning.

### Belysning

Der er monteret permanente lamper for generel belysning i forhal (4 x 40 Watt lavenergi). Derudover LED lamper der kan skifte farve. Foran A1-A3 er placeret lamper (42 Watt).

### Loft

Installation af el og netværk trækkes fra loft eller langs væg.

### Wirer

De fleste steder kan vi montere wirer med en vægt fra 0-75 kg. Wirer med en vægt over 75 kg kræver speciel godkendelse.

### Gulv

Gulvet er dækket af marmor/gulvtæppe.

Gulvet kan klare følgende belastninger:

Enkelkraft fordelt på 15 x 15 cm = 4.000 kg

Kørsel i områderne med udendørskøretøjer er ikke tilladt.

### Luft

Kongres Foyeren har aircondition.

## Congress Foyer – a brief description

### Accessing the Congress Foyer

Please refer to the floor plan where access points are indicated.

### Ceiling height

Measured from the floor to the lower edge of the lighting, the ceiling height is 250 cm.

### General lighting

Permanent lighting (4 x 40 Watt low energy). In addition, LED lights which can change color. In front of A1-A3 is lighting (42 Watt).

### Ceiling

Networking cabling will be supplied from the ceiling.

### Drop wires

Most places we can mount drop wires with a weight up to 75 kg. Drop wires exceeding 75 kg will require a special approval.

### Floor

The floor is covered with carpet/marble.

The floor can carry the following loads



Single point loads per 15 x 15 cm = 4.000 kg.

Outdoor vehicles are not allowed in the area.







### Air

The Congress Foyer has air conditioning.

## Kongres Foyer

	3x3mtr modul
	Søjle
	Brandskab Må ikke tildækkes
	Plantekumme
	Luftventilation, rørføring
	1. sal
	Hallens frihøjde

## Congress Foyer

	3x3mtr modular grid
	Pillar
	Fire hose Must not be concealed
	Plant bowl
	Ceiling ventilation, piping
	1st floor
	Ceiling height



# Kongres Foyer Congress Foyer

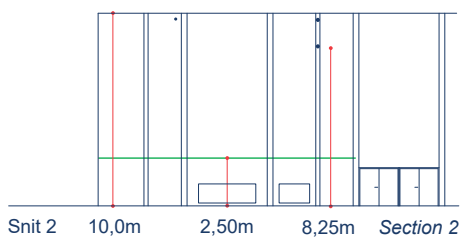
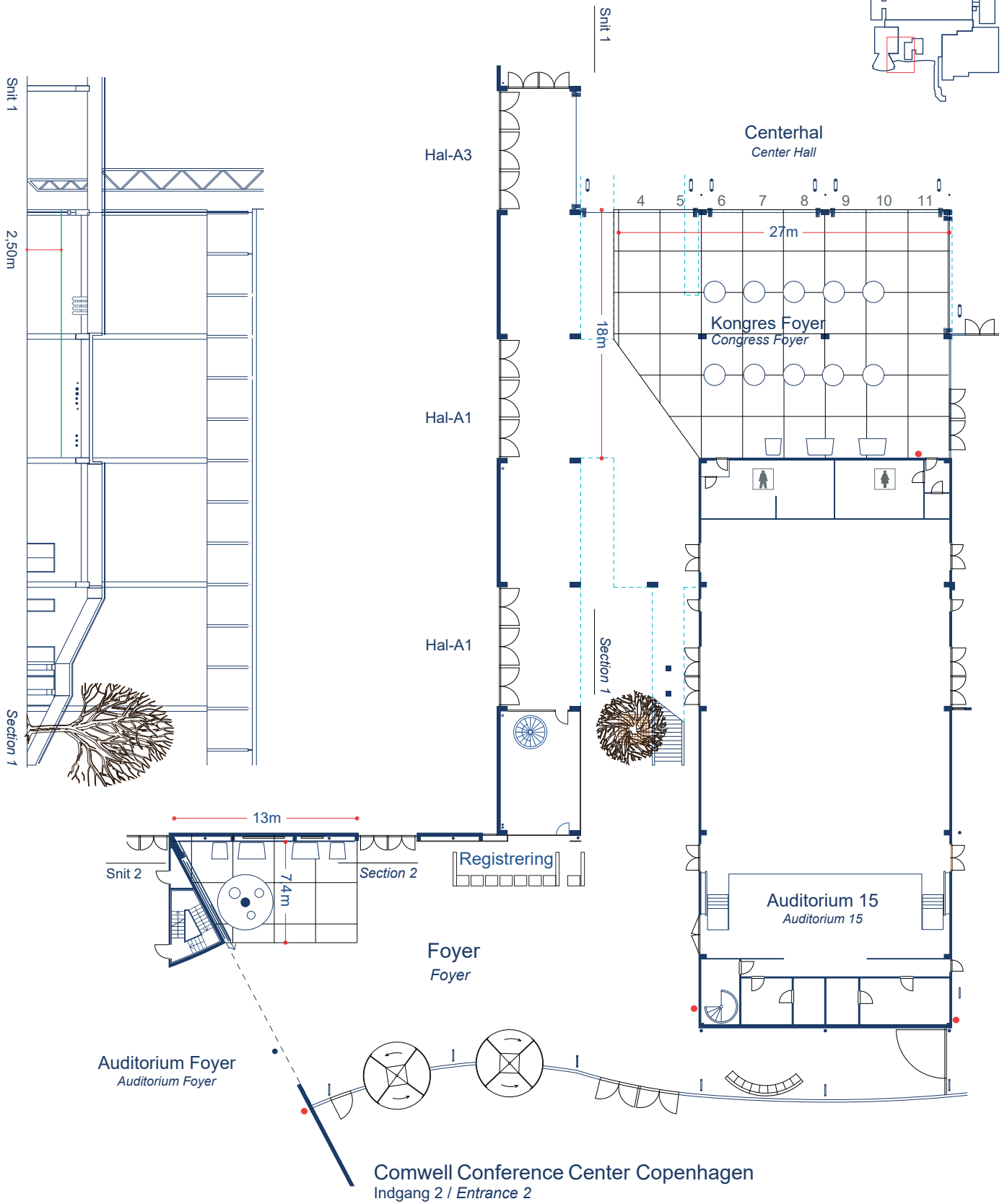
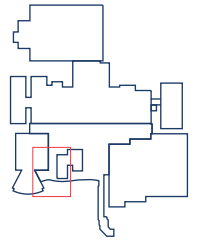

# Hal B

## – sådan ser den ud

### Adgang til hallen

På tegningen kan du se numrene for de enkelte døre, der giver adgang til hallen. Større gods skal leveres via port B5-8.

### Hallens frihøjder

Frihøjderne i hal B er: 3,0m / 3,35m.  
Se haltegningen på de følgende sider.

### Loft

Installation af el, VVS og netværk mv. sker fra loftet.

I hal B0-B2 skal al rigning ske fra de fastmonterede øskner i loftet. Den maksimale belastning af øsknerne er 49kg pr. punkt. Detailtegninger for stande vil indeholde information om riggepunkternes placering.

I hal B3-B6 er der ophængt et kabelbakkesystem, opdelt i 3x3m moduler. Kabelbakkesystemet er delt i 2 højder på henholdsvis 3,0m og 3,35m over gulv. Den maksimale belastning af kabelbakkeloftet er på 25 kg/m<sup>2</sup>. Vægskinnesystemet er ophængt 320cm over gulv.

### Belysning

I hal B0 hænger der lysskinner med 70watt metalhalogen spots. Lyset er fastmonteret og må kun justeres af Bella Center personale.

I hal B1-B2 hænger der lysskinner med 30watt LED spots.

I hal B3-B5 er der monteret lysskinner med 11 watt LED. 6 stk pr. 9m<sup>2</sup>. Desuden er der et lysarmatur med 3x14 watt pr. 9m<sup>2</sup>.

I hal B6 er der monteret 70watt halogenlampe 6 stk pr. 9m<sup>2</sup>. Desuden er der et lysarmatur med 3x14 watt pr. 9m<sup>2</sup>.

### Gulv

I hal B0-B2 er gulvet et meleret designgulv. I hal B3-B6 er gulvet lys gråmalet beton.

Gulvet kan klare følgende belastninger:

Hjultryk (tvingehjul)	5.500 kg/m <sup>2</sup>
Enkeltkraft fordelt på 15x15 cm	4.000 kg
Nyttelast	4.000 kg/m <sup>2</sup> (lastbil inkl. læs)

### Søjler









I hal B0 er søjlerne midt i hallen runde med en diameter af 55 cm og ved ydervægge er søjler 45x45 cm.

I hal B1-B6 er betonsøjlerne 50x50 cm, mens de ved ydervæggene er 25x50 cm.

### Luft

Hallen har aircondition.

#### Hal B

-  3x3m modul
-  Søjler Ø=50cm / 45x45cm / 50x50cm
-  Brandskab, L75xB25xH85cm  
må ikke tildækkes
-  Slangevinder, må ikke tildækkes
-  Hallens frihøjde
-  Ingen standopbygning
-  Ingen wireophæng
-  Anslag på søjle, B12xD11cm - H=290cm
-  Radiator
-  Vægskinnesystem. Højde over gulv 320cm.
-  Lysekrone. Højde over gulv 230cm.
-  Lysrig med spot. Højde over gulv 235cm.
-  Lysarmatur. 3x14W. Højde over gulv 235cm.
-  Der kan være enkelte restriktioner m.h.t. opbygning i disse områder.

### Hall B – a brief description

#### Accessing the hall

On the floor plan you find the numbers of each gate entrance to the hall. Larger goods must be delivered through gate B5-8.

#### Ceiling heights

Hall B consists of two ceiling heights: 3 m / 3.35 m. Please see the floor plan on the following pages.

#### Ceiling grid

Installation of electricity, VVS and network etc. will be supplied from the ceiling.

In hall B0-B2 all rigging must be made from the existing hooks in the ceiling. The maximum load on each hook is 49 kg. The stand details sketch will contain information about the placement of these hooks.

Hall B3-B6 is fitted with a modular ceiling grid, each measuring 3x3m. Heights as specified above. The grid is designed to withstand load of 25 kg per sq.m. Wall rails are mounted 320cm above the floor. (Marked with a red line).

#### Lighting

Hall B0 is mounted with spot rails containing 70watt metal halogen spots. The light is fixed and may only be adjusted by Bella Center staff.

Hall B1-B2 is mounted with spot rails containing 30watt LED spots.

Hall B3-B5 is mounted with spot rails containing 11 watt LED spots. 6 pcs pr 9 m<sup>2</sup> and a 3x14 watt low energy fluorescent light fitting per 3x3m grid module.

Hall B6 is mounted with spot rails containing 70watt halogen spots. 6 pcs pr 9m<sup>2</sup> and a 3x14 watt low energy fluorescent light fitting per 3x3m grid module.

#### Floor

In hall B0-B2 the floor is a mottled design floor. In hall B3-B6 the floor is concrete which is painted in a light grey colour.

The floor can carry the following loads:

Axle loads (twin wheels)	5,500 kg per sq.m.
Single point loads per 15x15 cm	4,000 kg
Net load (load minus weight of truck)	4,000 kg per sq.m.

#### Pillars















In hall B0 the center pillars have a diameter of 55 cm and against outer walls the pillars measure 45x45 cm.

In hall B1-B6 the concrete pillars measure 50x50 cm, whilst they measure 25x50 cm along outer walls.

#### Air

The hall has air conditioning.

#### Hall B

-  3x3m modular grid
-  Pillars Ø=50cm / 45x45cm / 50x50cm
-  Fire hose, cabinet L75xB25xH85cm  
- must not be concealed
-  Fire hose, drum - must not be concealed
-  Ceiling height
-  No Build-up
-  No drop wires
-  Rails on pillars, B12xD11cm - H=290cm
-  Radiator
-  Wall rails. Hight above the floor 320cm.
-  Chandelier. Hight above the floor 230cm.
-  Lighting truss with spot. Hight above the floor 235cm.
-  Light fixture. Hight above the floor 235cm.
-  It is possible that there will be some restrictions regarding build-up in these areas.

# Hal-B Hall-B

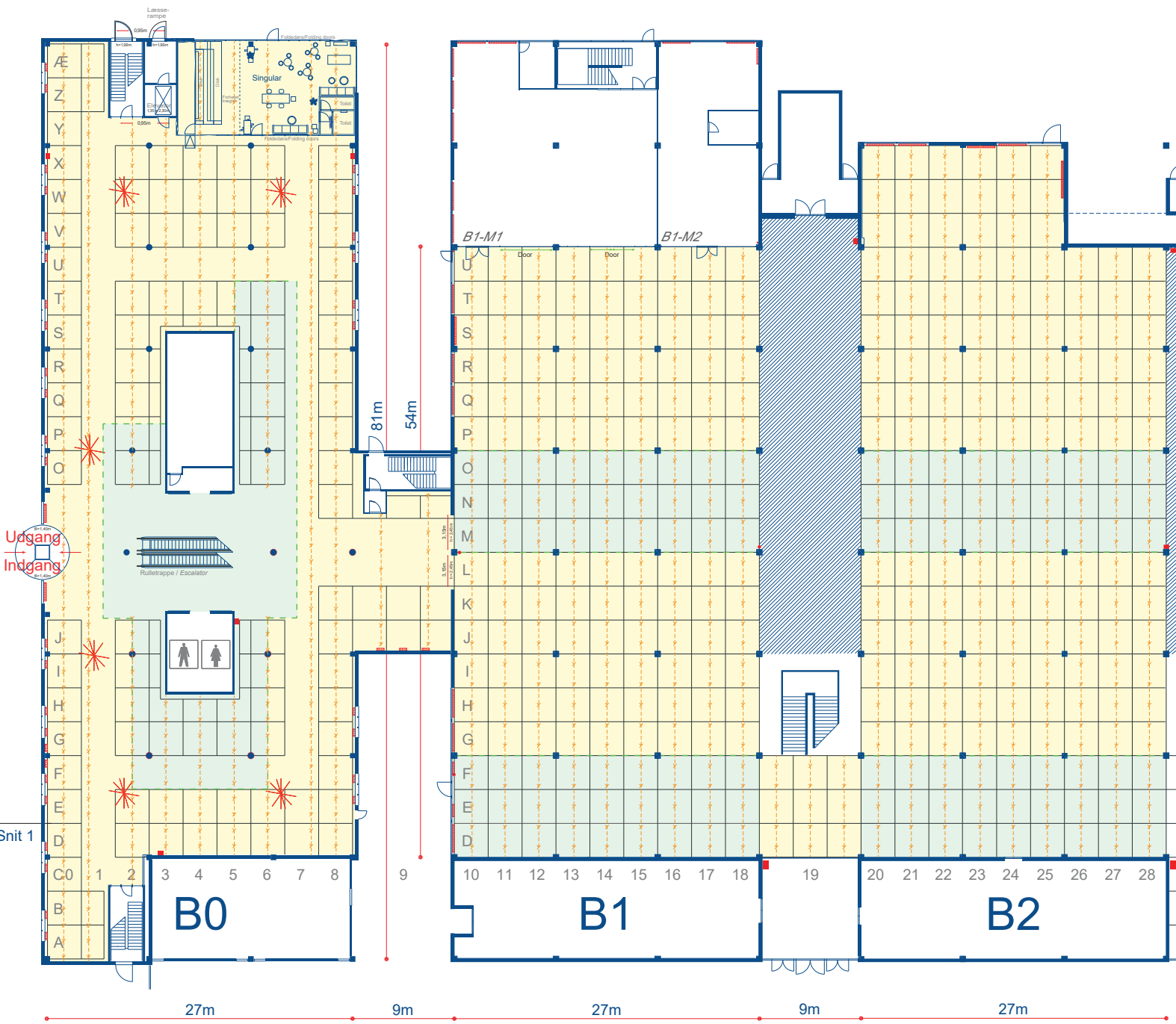
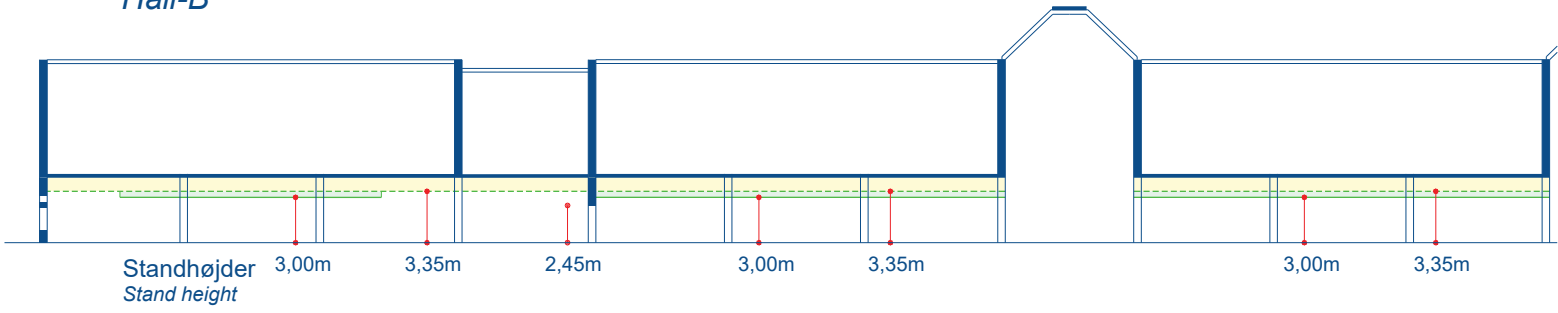

Hal-B  
Hall-B

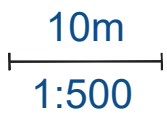
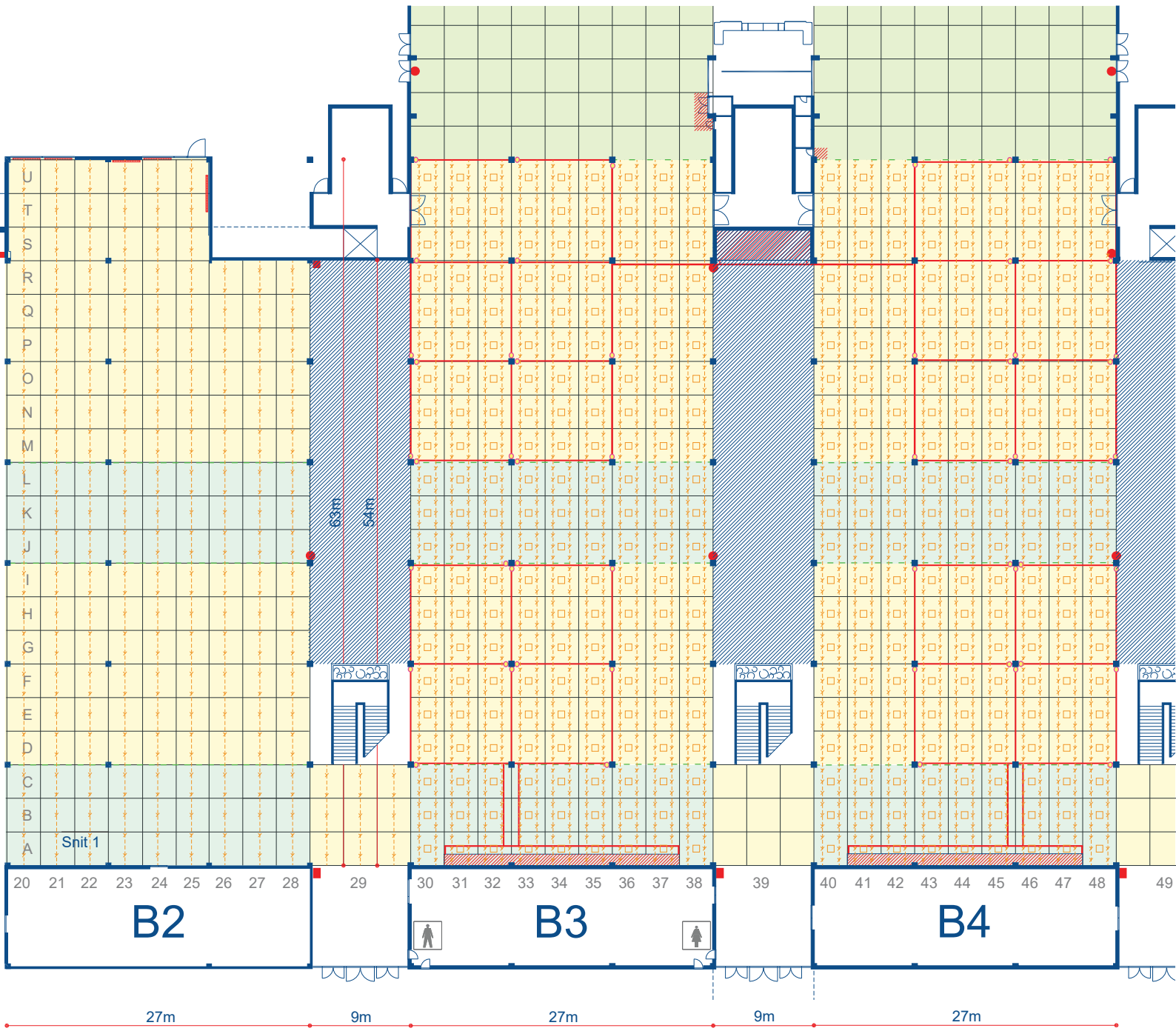
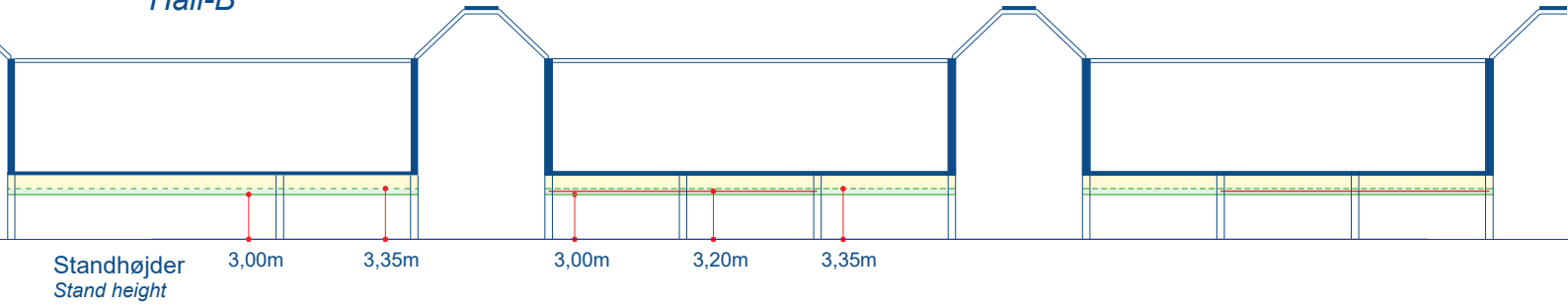

# Hal-B Hall-B

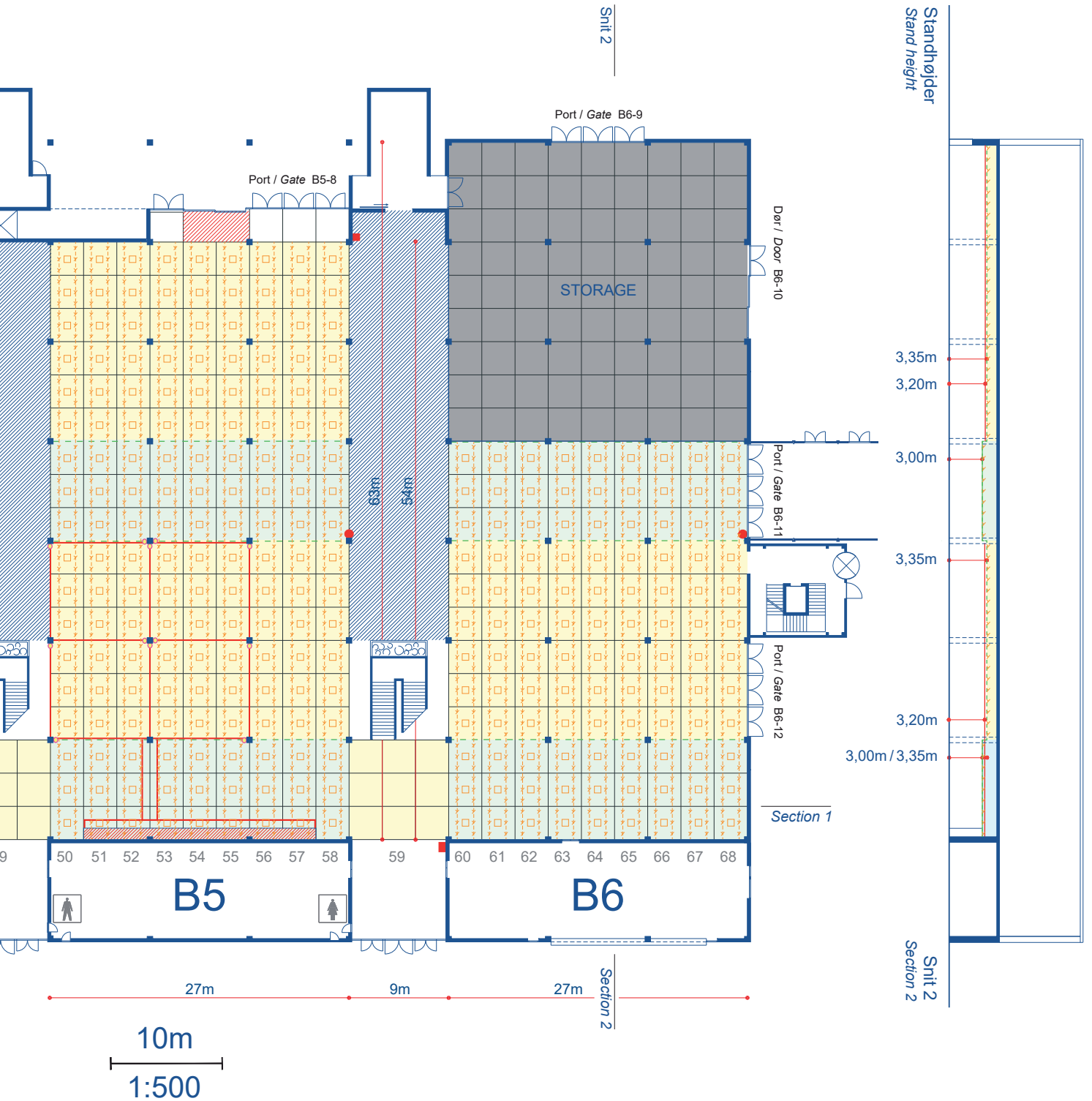
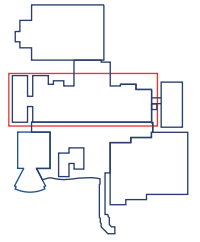
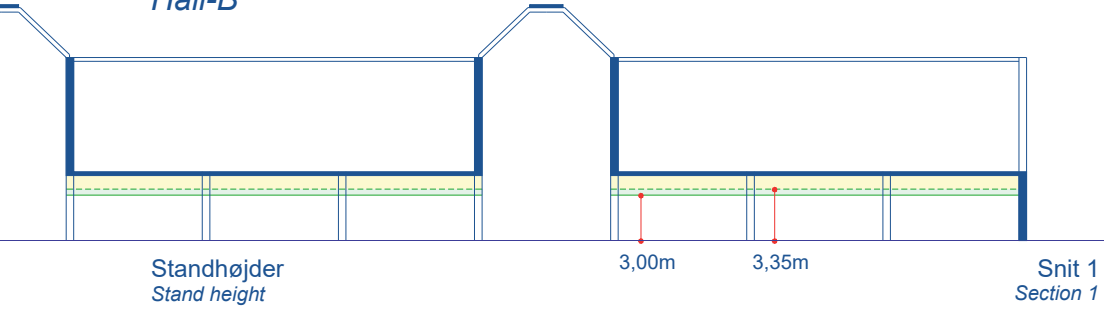

# Hal HB3/HB4

## – sådan ser den ud

### Adgang til hallen

På tegningen kan du se numrene for de enkelte døre, der giver adgang til hallen.

### Hallens frihøjde

Hallens frihøjde varierer fra 3,25 m under ventilationskanalerne, til 3,80 m under betondragerne. Se side 28.

### Belysning

I hallens loft hænger der lysrørsarmaturer (2x58 W) til den generelle belysning af hallen. I café området er der lamper med 3x24 W lamper.

### Gulv

Gulvet er gråmalet beton (farvekode NCS. 4502-Y).

Gulvet kan klare følgende belastninger:

Hjultryk (tvillingehjul)	5.500 kg/m <sup>2</sup>
Enkeltkraft fordelt på 15x15 cm	4.000 kg
Nyttelast*	4.000 kg/m <sup>2</sup>

\*Vægten af en lastbils last ud over lastbilens egen vægt.

### Loft

Installation af el, VVS og netværk med videre sker fra loftet.

### Søjler

Hallens betonsøjler er 40x75 cm eller 50x50 cm.

### Luft

Hallen har aircondition.

## Halls HB3/HB4 – a brief description

### Accessing the halls

Please refer to the floorplan where access points are indicated.

### Ceiling heights

The ceiling height varies from between 325 cm below the ventilation ducts and 380 cm under the concrete trusses.

Please see page 28.

### Lighting

Fluorescent light fittings (2x58 W), evenly distributed throughout the hall ceiling provide the general lighting. In café area is 3x24 W lighting.

### Hall floor

The hall floor is concrete, painted light grey (colour code NCS. 4502-Y).

The floor can carry the following loads:

Axle loads (twin wheels)	5,500 kg per sq.m.
Single-point loads per 15x15 cm	4,000 kg
Net loads*	4,000 kg per sq.m.

\*(load minus weight of truck)

### Ceiling

Power supplies, network and telephone cables as well as plumbing and compressed air will be run into your stand via the hall ceiling.











### Pillars

Free-standing concrete pillars measure 40x75 cm or 50x50 cm.











### Air

The hall has air conditioning.

### Hal HB

	3x3 m modul
	Søjle 40x75 cm
	Søjle 50x50 cm
	Brandskab, L75xB25xH85 cm, - må ikke tildækkes
	Slangevinder, må ikke tildækkes
	Hallens frihøjde
	Ventilation
	Ingen wireophæng
	Anslag på søjle, B12xD11 cm H=gulv til køreskinne
	Ingen standopbygning

### Hall HB

	3x3 m modular grid
	Pillar (concrete) 40x75 cm
	Pillar (concrete) 50x50 cm
	Fire hose, cabinet L75xB25xH85 cm - must not be concealed
	Fire hose, drum - must not be concealed
	Ceiling height
	Air conditioning
	No drop wires
	Walljamb on pillars, B12xD11 cm H=floor to top track
	No Build-up

# Hal HB3 / HB4

## Hall HB3 / HB4

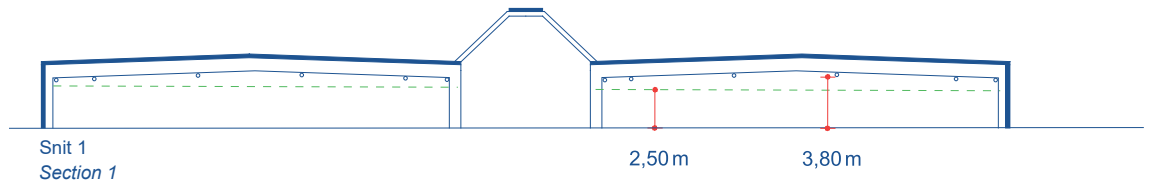
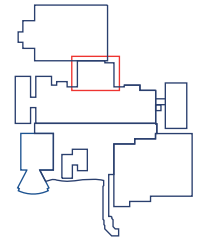

# Hal-H / Østhal

## Hall-H / East Hall

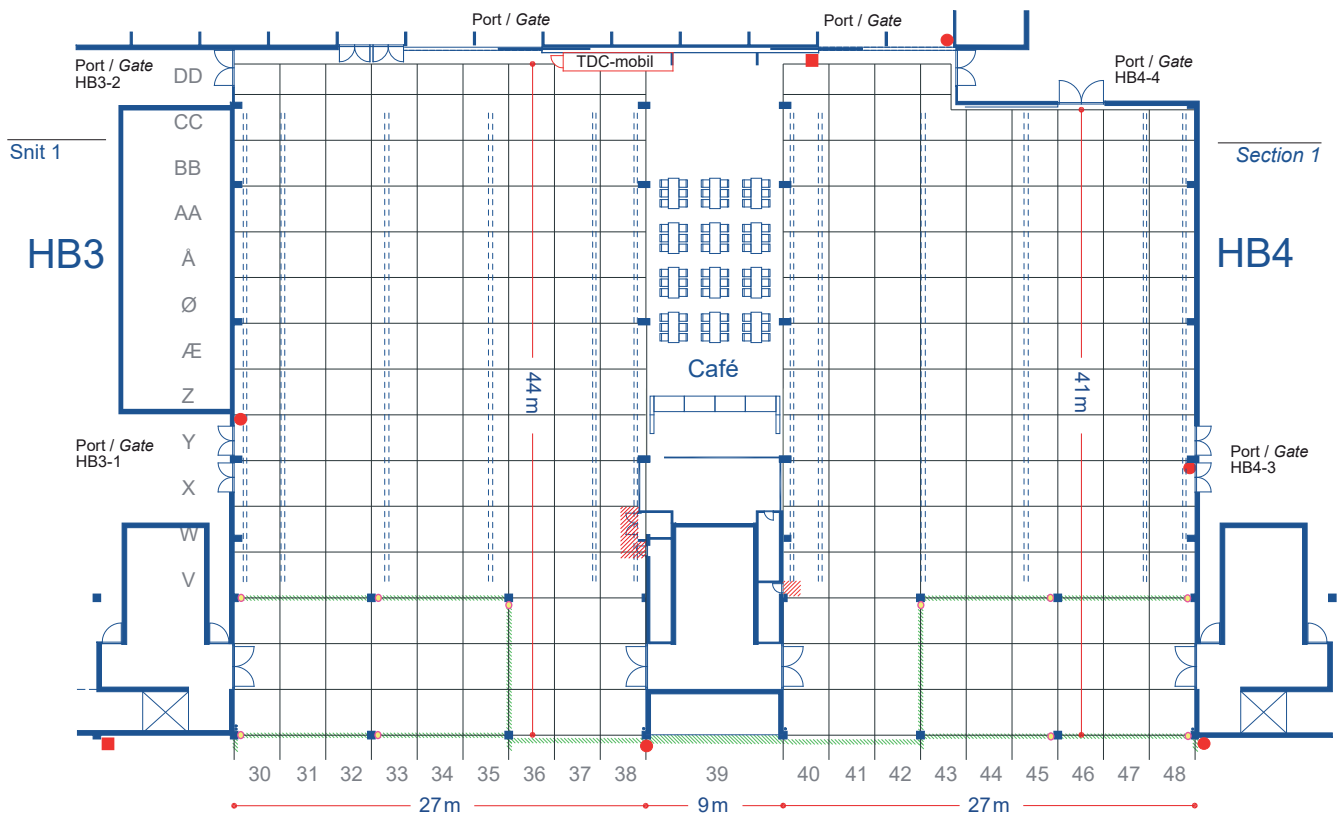

# Hal-B / Hall-B



# Hal C

## – sådan ser den ud

### Adgang til hallen

På tegningen kan du se numrene for de enkelte porte, der giver adgang til hallen.

### Hallens frihøjder

Hver af hallens fire sektioner har sin egen frihøjde, målt fra gulv til underkant lamper:

C1: 4,30m, C2: 5,85m, C3: 6,85m, C4: 6,85m. Se side 18.

### Belysning

Hallen er udstyret med permanent rigkonstruktion og messe-lamper. Løsningen kan tilkøbes jævnfør tilbud. Til den generelle belysning hænger der lysarmaturer. (3 x 58 W)

### Gulv

Gulvet er gråmalet beton (farvekode Ral 7038). Installation af el og VVS med videre sker via kanaler i hallens betongulv. Kanalernes indbyrdes afstand er 6 m.

Gulvet kan klare følgende belastninger:

Hjultryk (tvillingehjul)	5.500 kg/m <sup>2</sup>
Enkeltkraft fordelt på 15x15 cm	4.000 kg
Nyttelast*	4.000 kg/m <sup>2</sup>

\* Vægten af en lastbils last ud over lastbilens egen vægt.

### Wirer

Detailtegningen indeholder information om riggepunkternes placering. Wireophæng over 50 kg kan ikke monteres overalt i hallen. Bella Center forbeholder sig ret til at udføre småjusteringer.

### Loft

Netværk trækkes fra loftet og ned til standene.

### Søjler

De fritstående søjler i hallen er 40 x 80 cm og placeret for hver 9 meter. Søjlerne i ydervæggene er 35 x 40 cm.

### Luft

Hallen har aircondition.

### Hal C



3x3 m modul

- Søjle 40x80 cm
- Brandskab, L75xB25xH85 cm, må ikke tildækkes
- Slangevinder, må ikke tildækkes
- Gulvkanaler med installationer
- Hallens frihøjder
- Ventilation
- ▨ Ingen wireophæng
- ▨ Ingen wireophæng. Højde til underkant af ventilationsafskærmning 290 cm
- ▨ Wire max 15 kg
- Riggepunkt
- El bakker
- Skrå afstivning
- Lysrig med spot

### Hall C – a brief description

### Accessing the hall

Please refer to the floorplan where access points are indicated.

### Ceiling heights

Each of Hall C's four sections has its own ceiling height, measured from the floor to the lower edge of the lighting truss:

C1: 430cm, C2: 585cm, C3: 685cm, C4: 685cm.

Please see page 18.

### General lighting

The hall is equipped with permanent lighting truss. The solution is offered according to quote. General hall light fittings (3 x 58 W)

### Floor

The floor is concrete, painted light grey (colour code Ral 7038). Power supplies, telephone lines, plumbing and compressed air installations will, where possible, all be run into your stand via the subfloor services duct set into the floor at 6 m intervals.

The floor can carry the following loads:

Wheel loads (twin wheels)	5,500 kg per sq.m.
Single point loads per 15x15 cm	4,000 kg
Net loads*	4,000 kg per sq.m.

\* (load minus weight of truck)

### Drop wires

The detail sketch contains information about the placement of rigging points. Drop wires for 50+ kg cannot be mounted in all locations in the hall. Bella Center reserves the right to make minor adjustments.

### Ceiling

Networking cabling will be supplied from the ceiling.

### Pillars

40 x 80 cm free-standing concrete pillars line the arcade sections running east/west, at intervals of 9 m. Pillars let into the outer walls measure 35x40 cm wide.

### Air

The hall has air conditioning.

### Hall C



3x3m modular grid

- Pillar (concrete) 40x80 cm
- Fire hose, cabinet L75xW25xH85 cm - must not be concealed
- Fire hose, drum - must not be concealed
- Sub-floor service ducts
- Ceiling height
- Air conditioning
- ▨ No drop wires
- ▨ No drop wires. Hight from floor to lower edge of the ventilation screen is 290 cm
- ▨ Wire max 15 kg
- Rigging point
- Cable duct
- Cross-bracing
- Lighting truss with spot



# Hal-C, Gulv Hall-C, Floor



Snit  
Elevation

Centerhal  
Centerhall

Udendørsområde  
Outdoor area

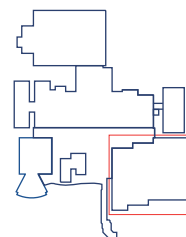
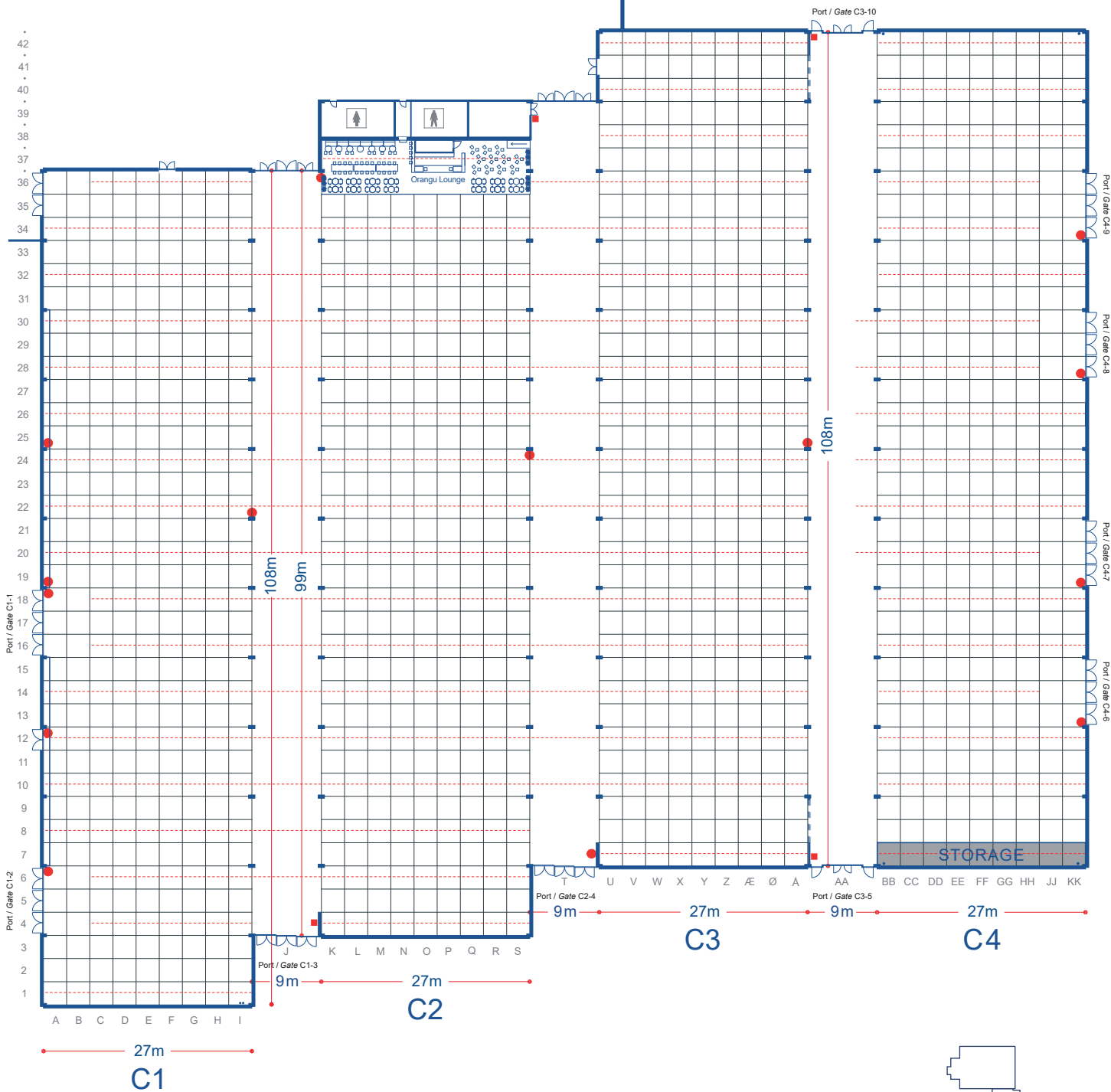

Hal-C, Loft  
Hall-C, Ceiling

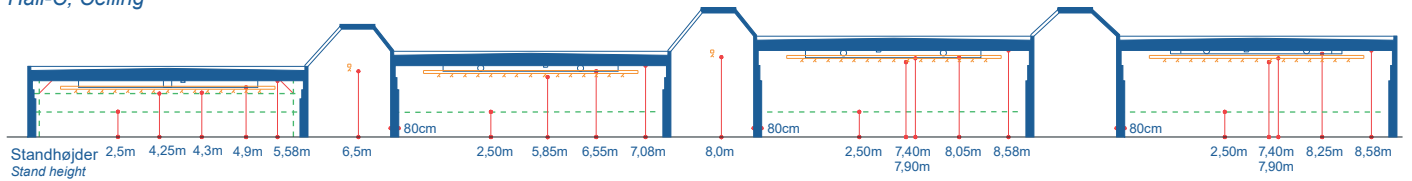

Centerhal  
Centerhall

Udendørsområde  
Outdoor area

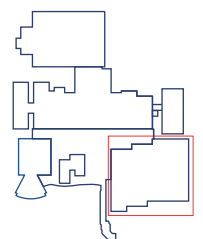
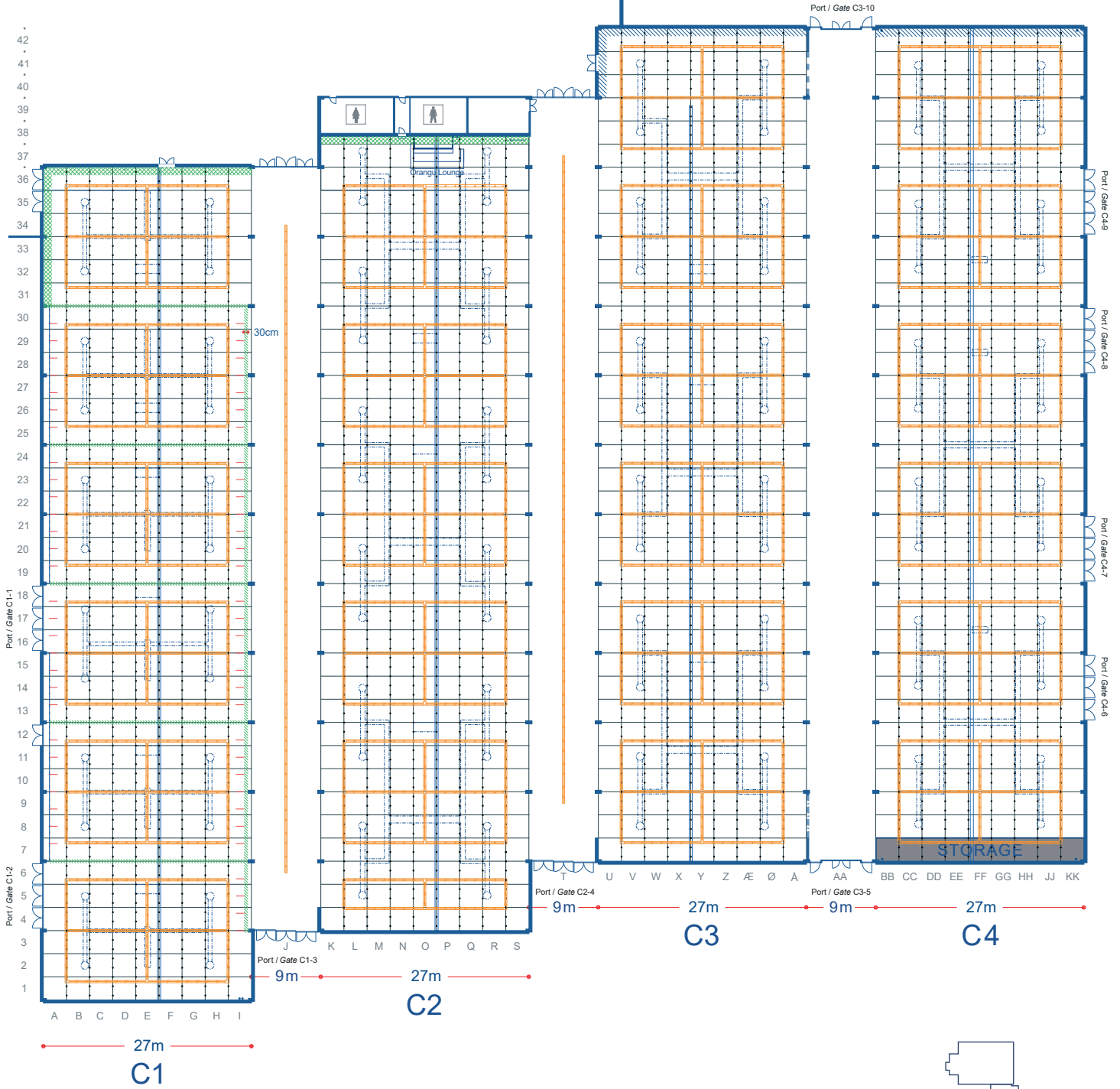

# Hal C5

## – sådan ser den ud

### Adgang til hallen

På tegningen kan du se numrene for de enkelte døre og porte. Hallens gulv er beliggende ca. 30 cm højere end øvrige gulve i Bella Center og der er kun ved port C5-3 adgang uden trin, men via kort rampe.

### Hallens frihøjder

Hallens frihøjde er 635 cm under rumgitter konstruktionen, Frihøjden reduceres lokalt af belysningsarmaturer, der er fastgjort til undersiden af rumgitteret. Rumgitteret har et vandret modul mål på 5,0 x 5,0 m.

Inden for 6 meters afstand fra facader og gavle må der højst opbygges i 2,5 meters højde. På det øvrige areal skal alle opbygninger over 3 meters højde udføres i ubrændbart eller svært antændeligt materiale og i forvejen godkendes af Københavns Brandvæsen i hvert enkelt tilfælde.

### Belysning

I hallens loft hænger 3 x 58 watt lav energi lysarmaturer for den generelle belysning af hallen.

### Gulv

Gulvet er ru støbekrydsfiner i brun farve. Gulvet kan klare en nyttelast på 800 kg/m.

### Wirer

Af konstruktionsmæssige årsager er det ikke muligt at rigge i loftet. Der kan dog i begrænset omfang ansøges om mulighed for opsætning af letvægtsbannere.

### Loft og facader

El og netværk trækkes dels langs facader og gavle dels fra loftet og ned til standene.

### VVS og afløb

Leveres i yderst begrænset omfang og kun i henhold til tilbud. Det er ikke muligt at sprinkle stande i 2 etager i denne hal, hvorfor man ikke kan forvente godkendelse af sådanne stande.

### Særlige forhold







Udstillingsstande med stor brandbelastning kræver særskilt godkendelse.

Kørsel i området er ikke tilladt

### Luft

Hallen har aircondition.

#### Hal C5

-  3 x 3mtr modul
-  Søjle
-  Brandskab, Slangevinder  
Må ikke tildækkes
-  IT-skab, L60xH70xD45cm  
Må ikke tildækkes
-  Hallens frihøjde
-  Luftventilation

## Hall C5 – a brief description

### Accessing the hall

Please refer to the floor plan where access points are indicated. The height of the floor is increase with approx. 30 cm. Access via ramp at gate number C5-3.

### Ceiling heights

Measured from the floor to the lower edge of the lighting, the ceiling height is 635 cm.

The ceiling height is 635 cm below the grating construction. The height is reduced locally by the luminaires, which are attached to the underside of the grating. The grating construction has a horizontal module measurement of 5.0 x 5.0 m.

Within 6 m. from the facade, the maximum building height is 2.5 m. For the rest of the hall, all workmanship in a height above 3 mtr, shall be carried out in non-flammable material, to be individually approved by the Danish Fire Department.

### General lighting

Luminaires. mounted with 3 x 58 Watt low energy lighting, evenly distributed throughout the hall ceiling, provide the general lighting.

### Floor

The floor is brown rough cast plywood. The floor can carry a net load of 800 kg/m

### Wirer

For construction reason rigging is not possible from the ceiling. You can apply for a permission to hang up low weight banners.

### Ceiling and facades

Networking cabling will be supplied along the facades and from the ceiling.

### Plumbing and drainage

Can only be supplied in accordance with quotation. It is not possible to sprinkle two storey stands in this hall, whereas you cannot expect approval of this kind of stands.

### Special conditions







Use of flammable exhibition items will require an individual approval.

Driving is not permitted in the area.

### Air

The hall has air conditioning.

#### Hall C5

-  3 x 3mtr modular grid
-  Pillar (concrete)
-  Fire hose, drum  
Must not be concealed
-  IT-cabinet L60xH70xD45cm  
Must not be concealed
-  Ceiling height
-  Ceiling ventilation

Hal-C5  
Hall-C5

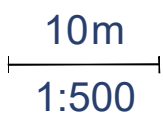
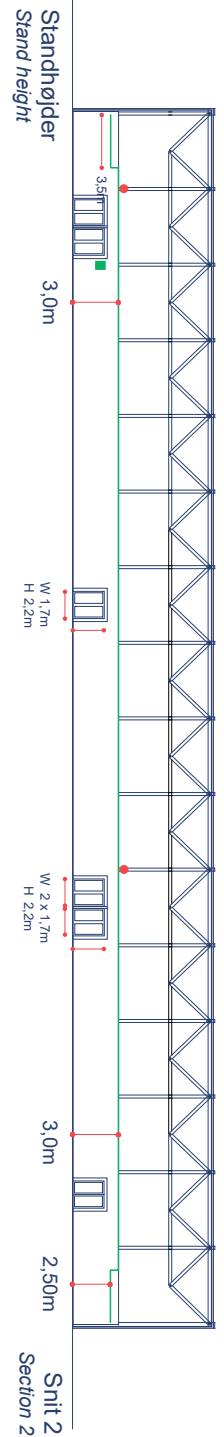
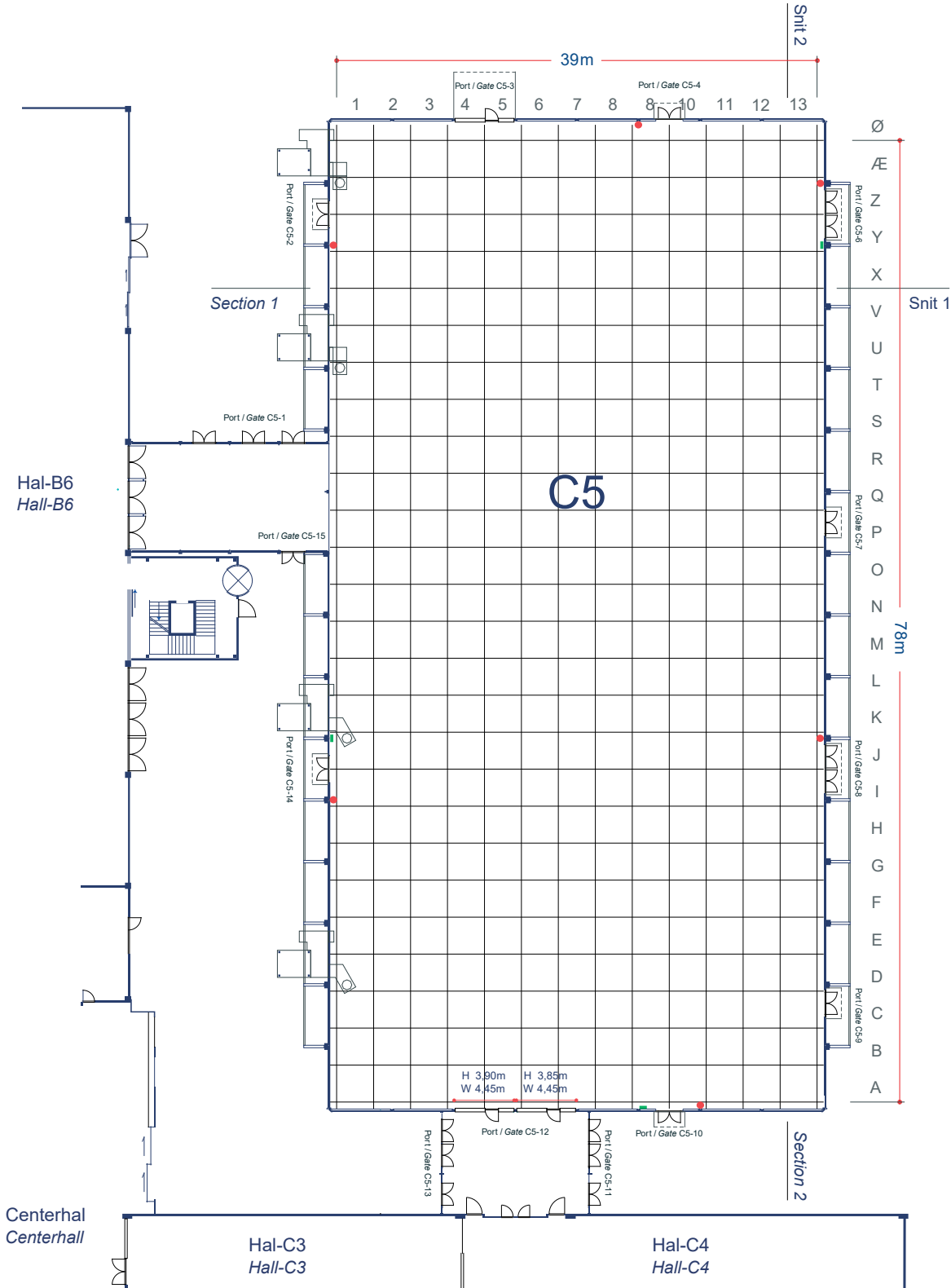
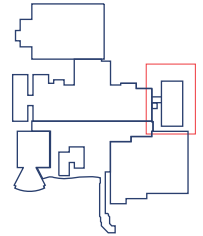
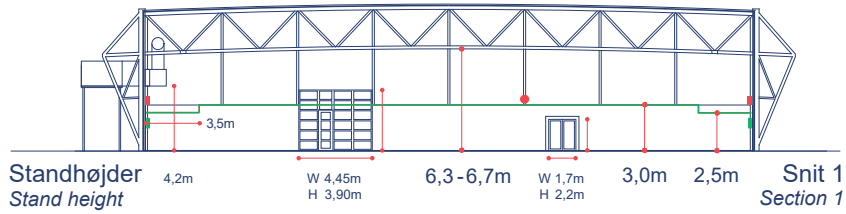

# Hal E / Centerhallen

## – sådan ser den ud

### Adgang til hallen

På tegningen kan du se numrene for de enkelte porte, der giver adgang til hallen.

### Hallens frihøjde

Hallens frihøjde, målt fra gulv til underkant af rig messelampe er 9,30 m. Se side 22-23.

### Belysning

Hallen er udstyret med permanent rigkonstruktion og messelamper. Løsningen kan tilkøbes jævnfør tilbud. Til den generelle hal belysning hænger der lysarmaturer (3x58 W).

Bemærk venligst, at på bestemte tidspunkter på året, kan sollys igennem glastaget, være til gene ved brug af pc, video, osv.

### Gulv

Installation af el, WS og netværk med videre sker via kanaler i hal- lens betongulv. Kanalerne ligger i hallens længderetning med en indbyrdes afstand på 15 m.

Gulvet kan klare følgende belastninger:

Hjultryk (tvillingehjul)	5.500 kg/m <sup>2</sup>
Enkeltkraft fordelt på 15x15 cm	4.000 kg
Nyttelast*	4.000 kg/m <sup>2</sup>

\* Vægten af en lastbils last ud over lastbilens egen vægt.

### Søjler

Hallens betonsøjler er 40x40 cm eller 40x80 cm.

### Luft

Hallen har aircondition.

## Hall E / Center Hall – a brief description

### Accessing Center Hall

Please refer to the floor plan where access points are indicated.

### Ceiling height

The ceiling height measured from the floor to the lower edge of the lighting truss is 9,30 m. Please see page 22-23.

### General lighting

The hall is equipped with permanent lighting truss. The solution is offered according to quote. General hall light fittings (3x58 W). Please note that at certain times of the year, sunlight from the glass roof can cause inconvenience with reflected light when using pc's, videos etc.

### Floor & services

Power supplies, network and telephone cables as well as plumbing and compressed air will, where possible, be supplied via the sub-floor service ducts let into the Centre Hall's concrete floor. These run from north to south at 1 500 cm intervals throughout the length of the hall.

The floor can carry the following loads:

Wheel loads (twin wheels)	5,500 kg per sq.m.
Single-point loads per 15x15 cm	4,000 kg
Net loads*	4,000 kg per sq.m.

\* (load minus weight of truck)









### Pillars

A limited number of free-standing concrete pillars are to be found in the northern end of the hall. These measure 40x40 cm or 40x80 cm.









### Air

The hall has air conditioning.

## Hal E (Centerhal)

	3x3 m modul
	Søjle 40x80 cm
	Søjle 40x40 cm
	Brandskab, L75xB25xH85 cm, må ikke tildækkes
	Gulvkanaler med installationer
	Foldevæg
	Ingen standopbygning
	Lysrig med spot

## Hall E (Center Hall)

	3x3 m modular grid
	Pillar (concrete) 40x80 cm
	Pillar (concrete) 40x40 cm
	Fire hose, cabinet L75xW25xH85 cm – must not be concealed
	Sub-floor service ducts
	Folding Wall
	No Build-up
	Lighting truss with spot

# Hal E / Centerhal

## Hall E / Center Hall

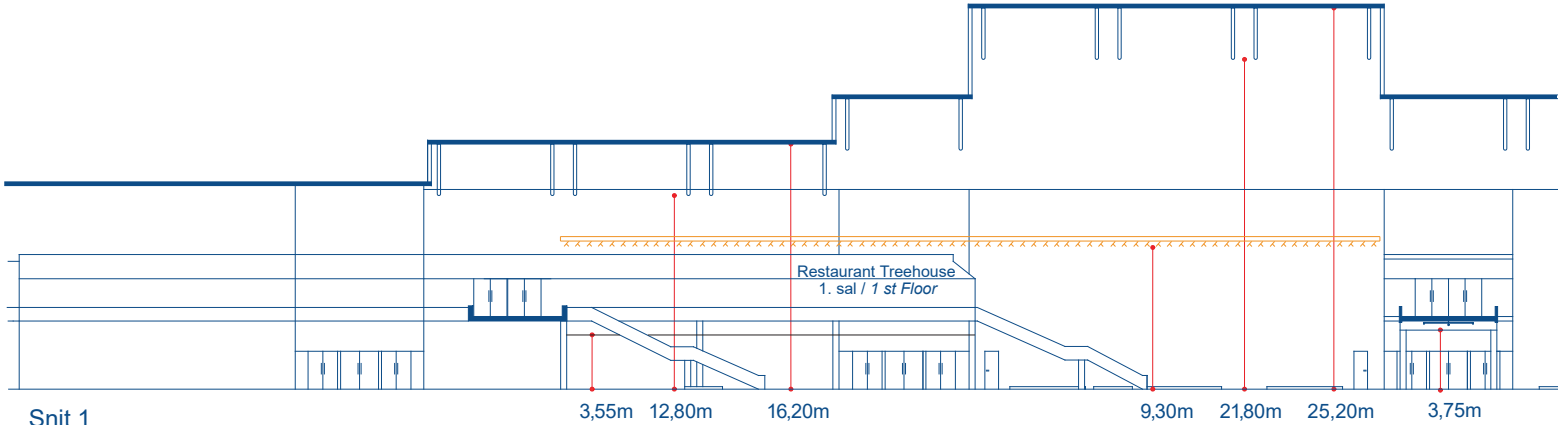

Snit 1  
Section 1

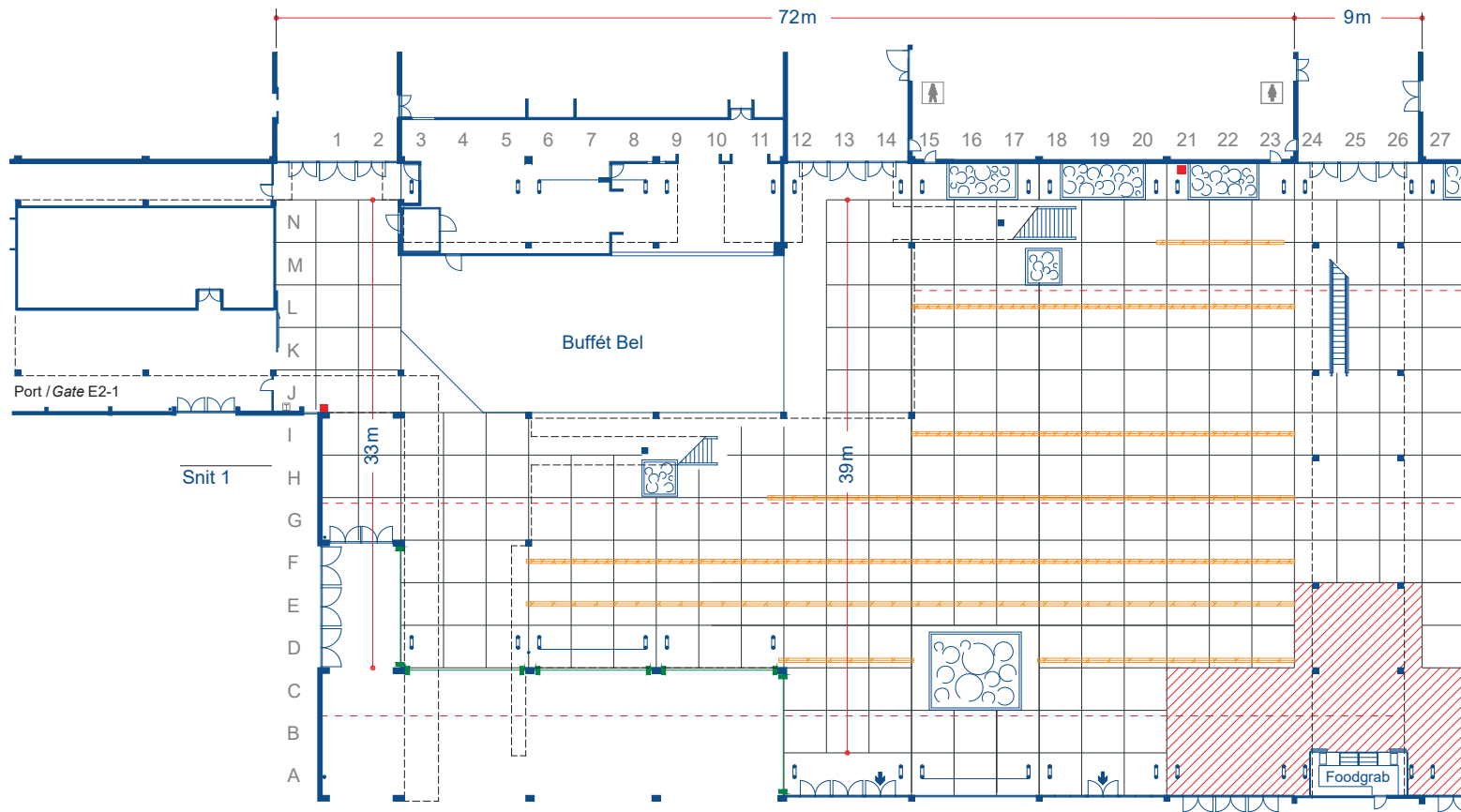

10m  
1:500

# Hal E / Centerhal

Hall E / Center Hall

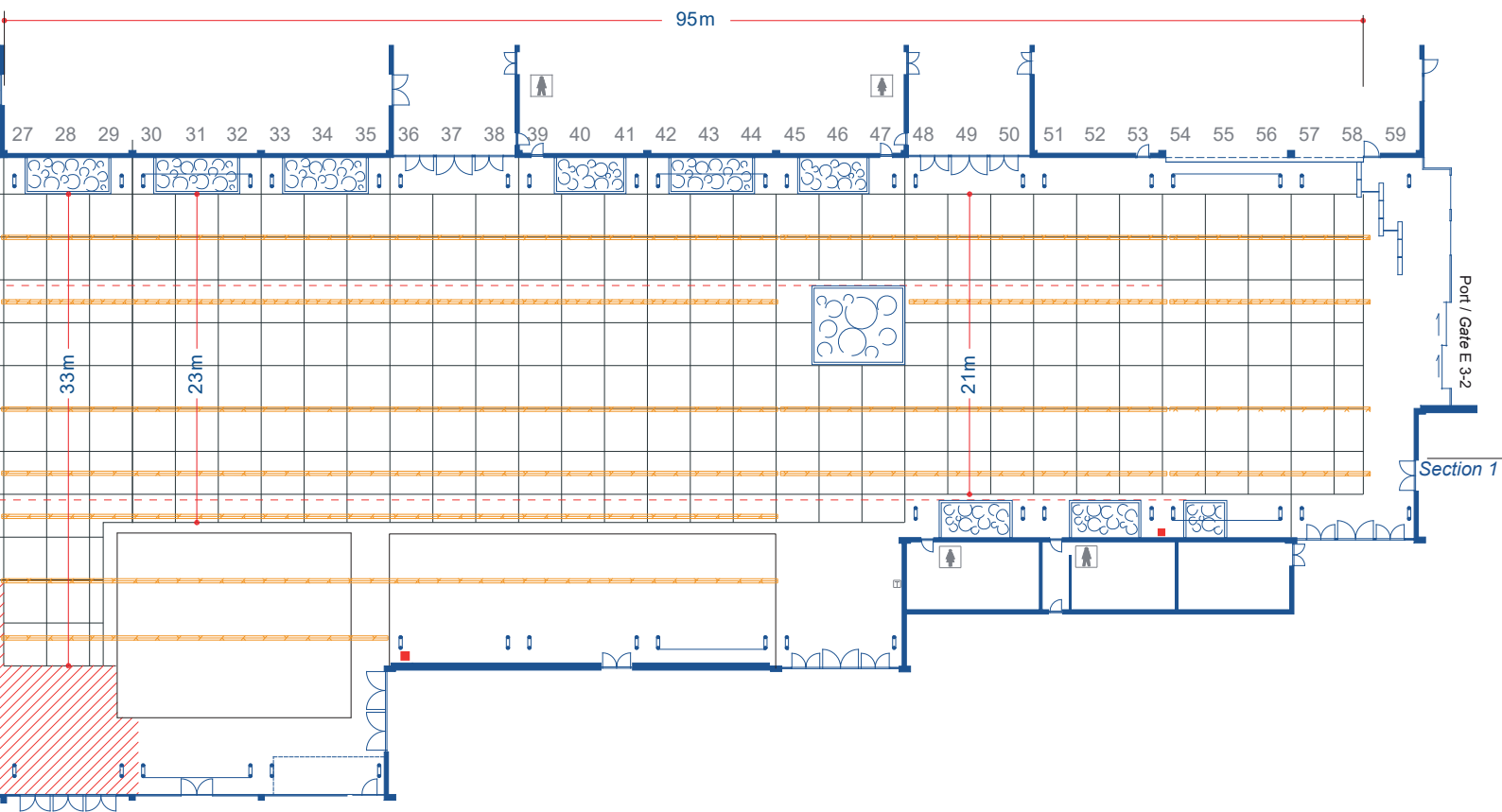
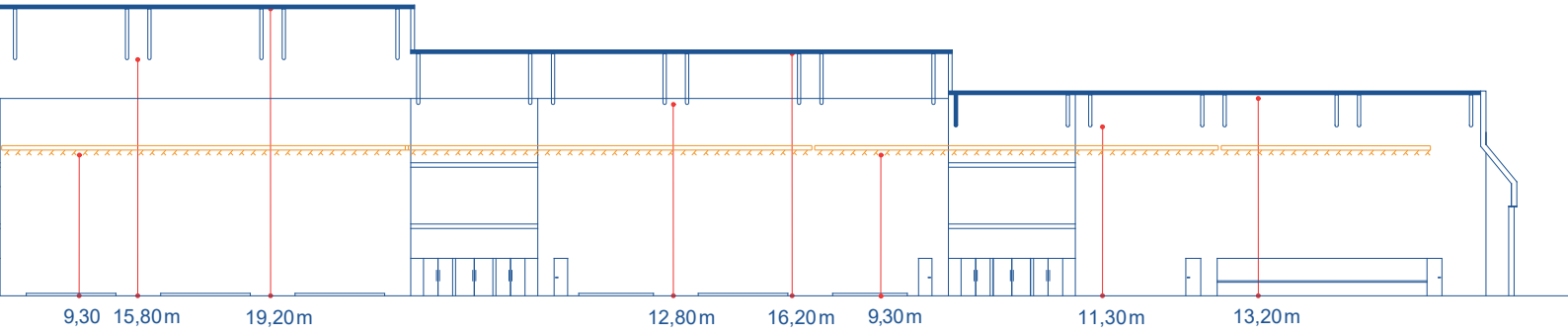
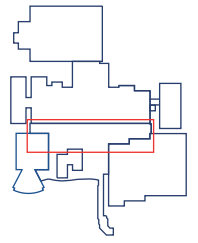

10m  
1:500

# Hal H / Østhallen

## – sådan ser den ud

### Adgang til hallen

På tegningen kan du se numrene for de enkelte porte, der giver adgang til hallen.

### Hallens frihøjde

Hallens frihøjde varierer fra 3,90 m til 6,10 m. Se side 25-26.

### Belysning

I hallens loft hænger der lysrørsarmaturer (3x58W) til den generelle belysning af hallen.

### Gulv

Gulvet er gråmalet beton.

Gulvet kan klare følgende belastninger:

Hjultryk (tvillingehjul)	5.500 kg/m <sup>2</sup>
Enkeltkraft fordelt på 15x15 cm	4.000 kg
Nyttelast*	4.000 kg/m <sup>2</sup>

\*Vægten af en lastbils last ud over lastbilens egen vægt.

### Loft

Installation af el, VVS og netværk med videre sker fra loftet.

### Wirer

De fleste steder i hallen kan vi montere wirer med en vægt fra 0-75 kg. Wirer med en vægt over 75 kg kan kun monteres direkte i spærene.

### Søjler

Hallens gråmalede træsøjler er 14x90 cm eller 14x60 cm.

På nogle af søjlerne er afløbsrør fastmonteret.

Målene fra midt søjle til midt søjle er 4,5 m (på langs i hallen).

### Luft

Hallen har ventilation/opvarmning.

## Hall H / East Hall – a brief description

### Access to hall

Please refer to the floorplan where access points are indicated.

### Ceiling Height

Due to the hall's sloping ceiling, the free height varies from 390 cm nearest the pillars to 610 cm along the central axis (north/south) of each hall section. Please see page 25-26.

### Lighting

Fluorescent light fittings, evenly distributed throughout the hall ceiling provide the general lighting.

### Floor

The floor is concrete, painted light grey.

The floor can carry the following loads:

Wheel loads (twin wheels)	5,500 kg per sq.m.
Single-point loads per 15x15 cm	4,000 kg
Net loads*	4,000 kg per sq.m.

\*(load minus weight of truck)

### Ceiling

Power supplies, network and telephone cables as well as plumbing and compressed air will be run into your stand via the hall ceiling.

### Drop wires

Most places in the hall we can mount drop wires with a weight of up to 75 kg. Drop wires exceeding 75 kg must be mounted directly into the rafters.

### Pillars

The free-standing, grey painted, wooden pillars measure 14x60 cm and are running north/south at intervals of 4.5 m.







Pillars built into the outer walls measure 14x90 cm.

Downpipes are installed on some pillars.







### Air

The hall has ventilation/heating.

### Hal H (Østhal)

	3x3 m modul
	Søjle 14x90 cm eller 14x60 cm
	Brandskab, L75xB25xH85 cm, må ikke tildækkes
	Slangevinder, må ikke tildækkes
	Vindkryds
	Ingen standopbygning
	Ventilation

### Hall H (East Hall)

	3x3 m modular grid
	Pillar (timber) 14x90 cm or 14x60 cm
	Fire hose, cabinet L75xW25xH85 cm – must not be concealed
	Fire hose, drum – must not be concealed
	Wind brace
	No Build-up
	Air conditioning



Hal H / Østhal  
Hall H / East Hall

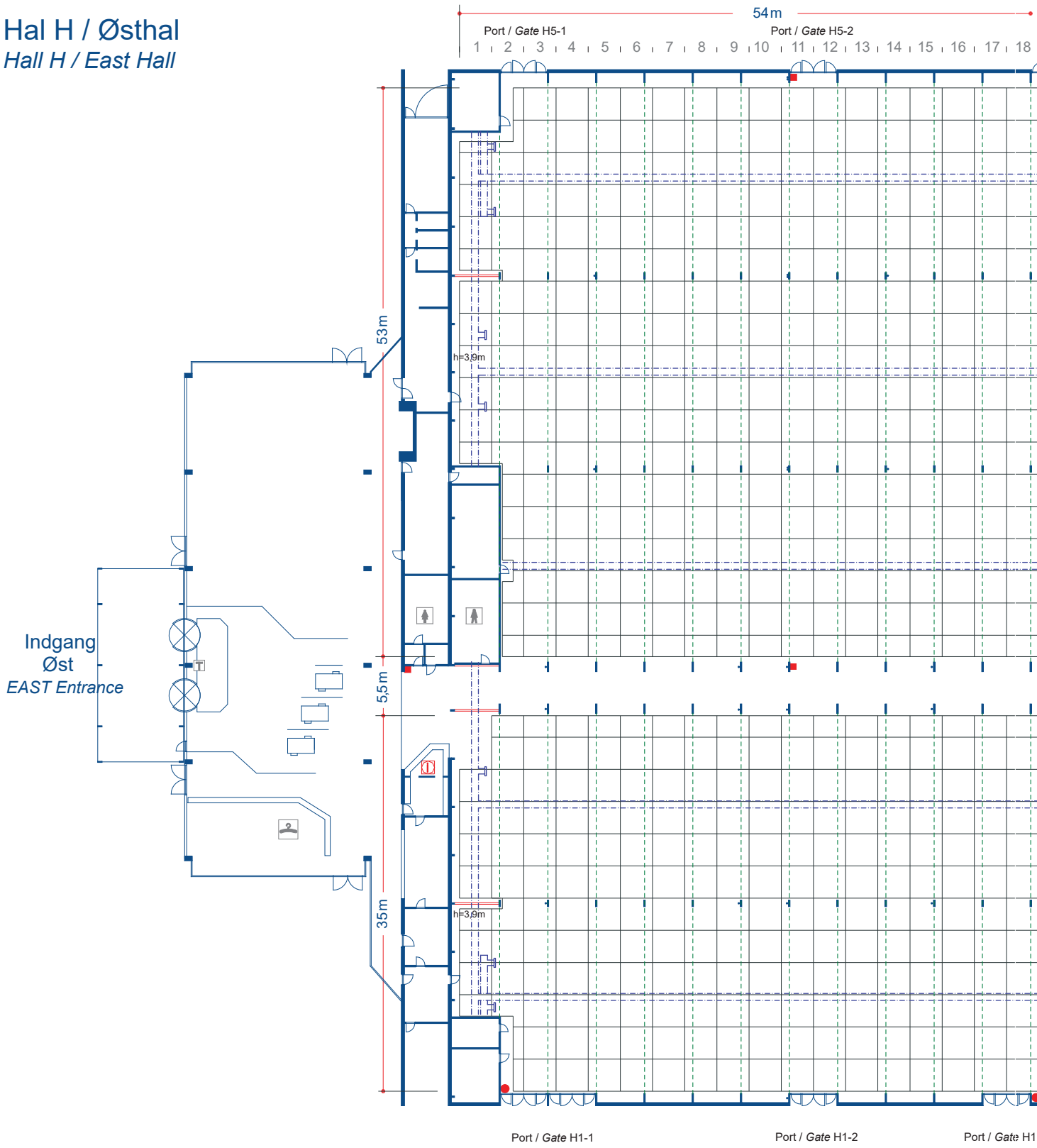

10m  
1:500

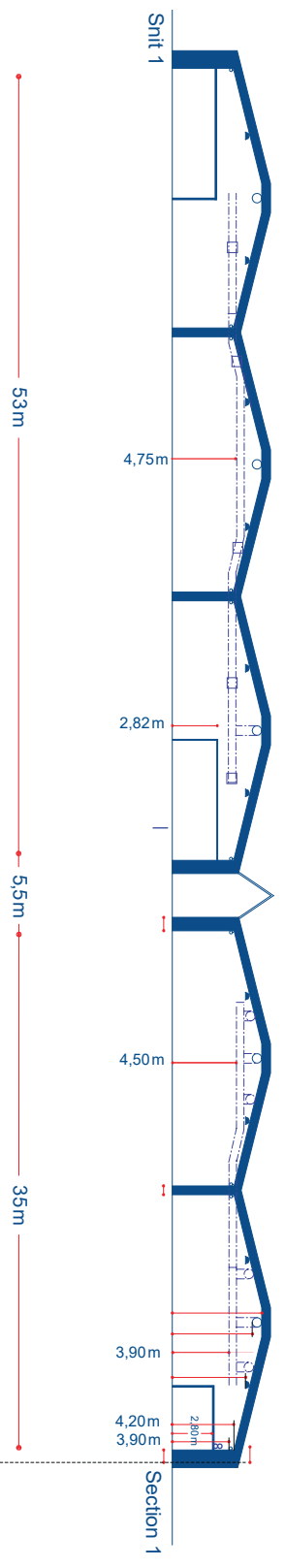
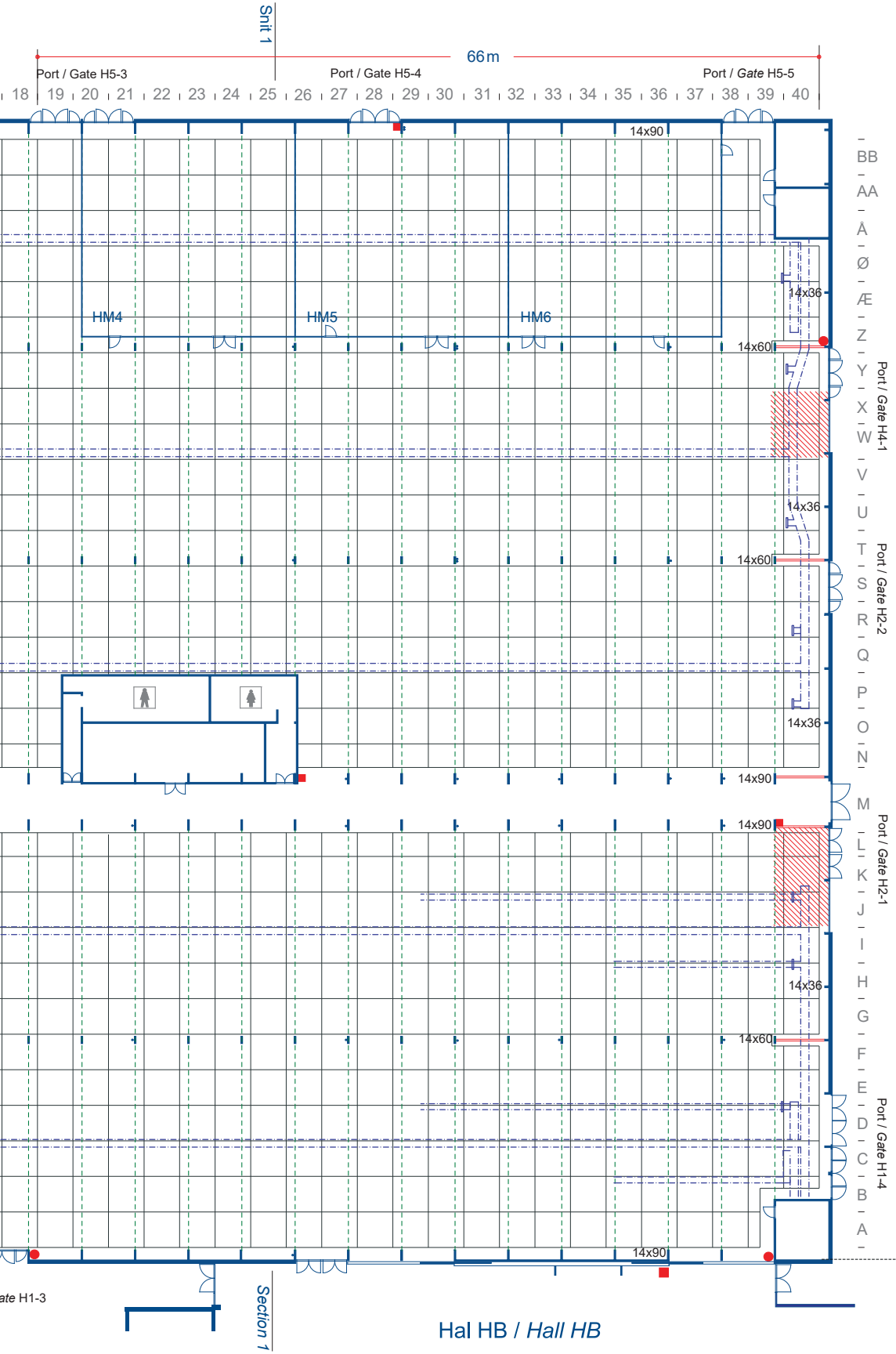

Hal HB / Hall HB

Section 1

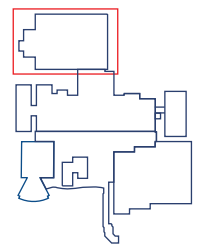
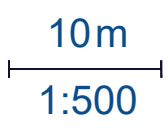

**Bella Center Copenhagen**

Center Boulevard 5

DK-2300 Copenhagen S

Tel +45 3252 8811

[bc@bellacenter.dk](mailto:bc@bellacenter.dk)

[bellacentercopenhagen.dk](http://bellacentercopenhagen.dk)